

1019

United States Department of the Interior
National Park Service

RECEIVED
JUL 06 1993
OHP
SEP 01 1993

National Register of Historic Places
Registration Form

NATIONAL REGISTER

This form is for use in nominating or requesting determinations for individual properties and districts. See instructions in *How to Complete the National Register of Historic Places Registration Form* (National Register Bulletin 16A). Complete each item by marking "x" in the appropriate box or by entering the information requested. If an item does not apply to the property being documented, enter "N/A" for "not applicable." For functions, architectural classification, materials, and areas of significance, enter only categories and subcategories from the instructions. Place additional entries and narrative items on continuation sheets (NPS Form 10-900a). Use a typewriter, word processor, or computer, to complete all items.

1. Name of Property

historic name PLUMMER, LOUIS, AUDITORIUM

other names/site number None

2. Location

street & number 201 E. Chapman Avenue

N/A not for publication

city or town Fullerton,

N/A vicinity

state California

code CA

county Orange

code 059

zip code 92632

3. State/Federal Agency Certification

As the designated authority under the National Historic Preservation Act, as amended, I hereby certify that this nomination request for determination of eligibility meets the documentation standards for registering properties in the National Register of Historic Places and meets the procedural and professional requirements set forth in 36 CFR Part 60. In my opinion, the property meets does not meet the National Register criteria. I recommend that this property be considered significant nationally statewide locally. (See continuation sheet for additional comments.)

Stade R. Craig
Signature of certifying official/Title

Aug 25, 1993
Date

California Office of Historic Preservation

State of Federal agency and bureau

In my opinion, the property meets does not meet the National Register criteria. (See continuation sheet for additional comments.)

Signature of certifying official/Title

Date

State or Federal agency and bureau

4. National Park Service Certification

I hereby certify that the property is:

- entered in the National Register. See continuation sheet.
- determined eligible for the National Register See continuation sheet.
- determined not eligible for the National Register.
- removed from the National Register.
- other, (explain): _____

Signature of the Keeper

Delores Byer

Entered in the National Register

Date of Action

9/30/93

5. Classification

Ownership of Property

(Check as many boxes as apply)

- private
- public-local
- public-State
- public-Federal

Category of Property

(Check only one box)

- building(s)
- district
- site
- structure
- object

Number of Resources within Property

(Do not include previously listed resources in the count.)

Contributing	Noncontributing	
1	0	buildings
		sites
		structures
		objects
1	0	Total

Name of related multiple property listing

(Enter "N/A" if property is not part of a multiple property listing.)

N/A

Number of contributing resources previously listed in the National Register

0

6. Function or Use

Historic Functions

(Enter categories from instructions)

Recreation and Culture: Auditorium

Current Functions

(Enter categories from instructions)

Recreation and Culture: Auditorium

7. Description

Architectural Classification

(Enter categories from instructions)

Late 19th and 20th Century Revivals

Spanish Colonial with Italian

Renaissance elements

Materials

(Enter categories from instructions)

foundation poured-in-place concrete

walls poured-in-place concrete

roof red clay tiles

other

Narrative Description

(Describe the historic and current condition of the property on one or more continuation sheets.)

The imposing south-facing front facade of the 40,950-square-foot Plummer Auditorium is symmetrical in design and richly decorated with Neo-Classical motifs. The wide variety of cast concrete emblems adds interest and character to the front facade, embellishing the classically-shaped parapet, windows and rectangular portico. A red-tile-clad gabled roof is attached to the back of the uniquely-shaped parapet and red-clay-tile-clad shed-style roofs form narrow rows along the east and west facades. On the west elevation, the shed-style roof shelters a dramatic fifteen-arch arcade. The four-story-high tower is crowned with a dome clad in mosaic tile in rich shades of blue and gold. All four faces of the tower contain large clocks featuring Roman numerals. The interior is crowned with an elaborate ceiling of painted beams, the original wrought iron chandeliers, arched side isles with composite capitals, and other character-defining architectural elements. Plummer Auditorium is located on a prominent corner on Chapman Avenue, Fullerton.

**United States Department of the Interior
National Park Service****National Register of Historic Places
Continuation Sheet**Plummer , Louis, Auditorium
Orange County, CaliforniaSection number 7 Page 2

main East-West street. A well-maintained lawn, sprinkled with trees, is located immediately to the west and is approximately 85' x 225'. The building retains its integrity of location, setting, design, workmanship, materials, feeling and association.

Roofscape:

The prominent roof ridge of the decorative front gable features a narrow border at the top, a lyre, representing music, in the center of the decorative pediment at the peak, and small pediments at each end. Those pediments are accented with comedy and tragedy masks. This is a very good example of a false front with front-facing gabled roof attached to the rear. The roof is clad in red clay tiles. Approximately fifteen feet below the main roof, on the east and west sides, are shed-style roofs clad in red clay tiles. The roofs run almost the entire length of the east and west sides. A single-storied flat-roofed arcade forms a row of fifteen arches along the west side. The roof of the projecting portico in the center of the front facade is flat and finished as a balcony with a solid rail that forms the top of the portico. The rear one-eighth of the building is approximately 20 feet taller than the main section and denotes the stage section where the mechanisms to control the curtains and the sets are located.

Front Facade:

Symmetrical in form, the front facade is centered with an elaborate rose window. Moderne pilasters accent the corners, below the corner pediments. The words "Louis E. Plummer Auditorium" are centered above the wide doorway which leads to the balcony above the projecting portico. A trio of blind windows, elaborately surrounded with squares in a classical motif and crowned with a wide decorative cornice, flank each side of the center section. A second pair of Moderne pilasters forms the edges of the outside walls. A wide portico, featuring three matching arched openings with beautifully-detailed cast concrete decoration, is a good example of conservative classicism. Three tiers of pilasters and cornices reach from the top of the balcony to the base of the portico, with the four pilasters separating and flanking the three arches. A large cartouche crowns the central arch. Rusticated stones accent the inside face of each arch, and outline the three rectangular panels above the openings. The pilasters are topped with unique capitals featuring acanthus leaves and shields. Wide concrete steps, flanked by concrete piers, lead to the portico. A tall and elaborate wrought iron lamp adorns each pier. Two wrought iron railings separate each of the three sections of stairway.

The three identical arches lead to the rectangular interior of the portico. A wrought iron lamp hangs from each of the three vaults of the portico ceiling. Ticket windows with elaborate surrounds and cornices are located on the east and west sides of the interior. Three sets of doors leading to the lobby are contemporary metal and glass, one of the few alterations to the exterior of this fine building.

East Facade:

A narrow shed-style roof, clad in red clay tiles, forms a row along the east facade, approximately fifteen feet below the eave of the main gabled roof. A row of blank arches, filled in with black and white and yellow and white ceramic tiles, is located between the main and shed-style roofs. A side entrance, topped with an arched opening and flanked by cast concrete pilasters and ornate capitals, is placed close to the front (south) facade. Concrete piers, tipped with wrought iron rails, border each side of the stairs. The

United States Department of the Interior
National Park Service

National Register of Historic Places
Continuation Sheet

Plummer, Louis, Auditorium
Orange County, California

Section number 7 Page 3

original patterned metal door, which matches those used throughout the first floor of the building, is deeply recessed from the entry arch. The east facade is blank between the side entrance on the south and a similar and plainer entrance at the north end. The low hipped roof of the stage and the vertical wall that extends above the main gabled roof occupy the rear one-eighth of the building are visible from the east side.

West Facade and Tower:

The main attractions of the west facade are the impressive and beautifully-decorated five-story tower and the arcade featuring fifteen arches. The tower, reminiscent of those located at the Mission Santa Barbara, is crowned with an octagonal dome clad in blue and gold ceramic tiles. Elaborate cornices, with decorative pediments at each corner, cap the twin arched openings which occupy each side of the belfry. Chevrons decorate the corner pilasters which flank each set of openings. Another wide cornice separates the twin arches of the belfry and the single arched opening below. These openings, surrounded by ceramic tiles in blue, gold, and green, are centered in the middle of each section. A narrow balcony, accented with carved brackets and pilasters, is attached to each single arched opening. Large clock faces, consisting of Roman numerals, are centered in each facade, below the balconies. The clocks were made by the shop department of the high school. The remainder of the tower is plain concrete, with a few small recessed multi-paned windows. At the bottom of the west side is an arched opening with an elaborate surround. The recessed opening has been filled in with a plain recessed wall.

The single-storied arcade, which runs along the west facade, is topped with a flat roof, and extends from a point ten feet from the front facade to the north side of the tower, extending 13 feet beyond the tower. Fifteen arches, separated by pillars with unusual capitals featuring chevrons, form a neat row along the west side. The first, or southernmost, arch is accented by molding and urn-like decorative elements. It serves as the south entrance to the arcade. Seven steps, flanked by concrete piers, lead to the opening. The floor of the arcade is clad in large red clay tiles.

North Facade:

The rear of the building is visible from very few angles, due to the proximity of the music arts building to the north and east and the arcade on the west. A small patio between the two buildings has been enclosed for storage and restrooms. (Please see enclosed floor plan). The addition is clad in plain stucco, has no architectural elements, and is topped with a flat roof.

Interior:

The richly-decorated interior features the same strong classical ornamentation as the exterior. The ceiling, with its original painted and decorated rough-hewn beams and wrought iron chandeliers, is very Spanish in influence. The front of the balcony is accented with a row of blank arches and corbels. The aisles down each side are embellished with composite capitals. The same design is featured in the large capital faces along each side wall. The original metal doors, featuring decorated squares, are located in the center of each side wall.

Elaborate balconets, centered with arched openings and flanked by pairs of tall, narrow openings, occupy the diagonal walls on each side of the procenium. Finials cap the corners and a decorated pediment tops the central arch. Carved brackets underscore the decorative sill below the openings. A different saying is featured on each balconet.

**United States Department of the Interior
National Park Service**Plummer, Louis, Auditorium
Orange County, California**National Register of Historic Places
Continuation Sheet**Section number 7 Page 4

They read: Knowledge is in Every Country the Surest Basis of Public Happiness, and, This Country, With its Institutions, Belongs to the People Who Inhabit It. Pairs of doors, which match those on the sides, lead to the backstage area.

The entrance hall is the same length, east to west, as the auditorium and features its original arched ceiling and crown molding. The balcony is reached through arched openings at each end of the hall. The staircases, recessed into the front wall, are bordered by wrought iron railings and columns. The trio of glass and metal front doors are not original, but fill the original spaces. The wall between the hall and the auditorium was changed to a plain wall when the auditorium seating plan was changed in 1972.

The auditorium seats were replaced with new ones and the seating plan changed from a center aisle arrangement to a side aisle configuration in 1972. The wide entrance at the back was walled over and the side entrances became the access for the auditorium. The walls, ceiling, balcony and decorative elements were not altered, allowing the auditorium to retain its integrity of architectural design and character. Some changes have recently been made to the backstage area and the sound system. The famous Whurlitzer organ remains the same in appearance, with the inner workings converted to a more modern system. The interior of the building, seen by thousands of people throughout its 63 year existence, retains the same unique character planned by architect Carlton Winslow in 1930.

Setting:

The actual setting of the Plummer Auditorium has changed little since it was constructed in 1930 because those building more recent buildings on the grounds had the sensitivity to place the newer buildings to the rear of the large expanse of lawn to the west of the auditorium. The original (1912) school buildings were located approximately 250 feet to the west, on a site now occupied by two buildings constructed in 1949. Other buildings to the rear of the auditorium, were built between 1947-1953. This includes the Music-Speech-Arts Building directly to the north of the auditorium. The only building over 50 years old, with the exception of the auditorium, is the gymnasium, located in the opposite corner of the campus, and dated 1925. The building to the rear of the lawn area was built in the 1970's and is hidden substantially by the landscaping. Plummer Auditorium sits alone on a prominent corner, with its front facade in full view.

8. Statement of Significance

Applicable National Register Criteria

(Mark "x" in one or more boxes for the criteria qualifying the property for National Register listing.)

- A** Property is associated with events that have made a significant contribution to the broad patterns of our history.
- B** Property is associated with the lives of persons significant in our past.
- C** Property embodies the distinctive characteristics of a type, period, or method of construction or represents the work of a master, or possesses high artistic values, or represents a significant and distinguishable entity whose components lack individual distinction.
- D** Property has yielded, or is likely to yield, information important in prehistory or history.

Criteria Considerations

(Mark "x" in all the boxes that apply.)

Property is:

- A** owned by a religious institution or used for religious purposes.
- B** removed from its original location.
- C** a birthplace or grave.
- D** a cemetery.
- E** a reconstructed building, object, or structure.
- F** a commemorative property.
- G** less than 50 years of age or achieved significance within the past 50 years.

Areas of Significance

(Enter categories from instructions)

Architecture

Performing Arts

Period of Significance

1930-1943

Significant Dates

1930

Significant Person

(Complete if Criterion B is marked above)

N/A

Cultural Affiliation

N/A

Architect/Builder

Architect: Winslow, Carlton M.

Builder: Ames, Edwin

Narrative Statement of Significance

(Explain the significance of the property on one or more continuation sheets.)

9. Major Bibliographical References

Bibliography

(Cite the books, articles, and other sources used in preparing this form on one or more continuation sheets.)

Previous documentation on file (NPS):

- preliminary determination of individual listing (36 CFR 67) has been requested
- previously listed in the National Register
- previously determined eligible by the National Register
- designated a National Historic Landmark
- recorded by Historic American Buildings Survey # _____
- recorded by Historic American Engineering Record # _____

Primary location of additional data:

- State Historic Preservation Office
- Other State agency
- Federal agency
- Local government
- University
- Other

Name of repository:

Fullerton City Hall

United States Department of the Interior
National Park ServiceNational Register of Historic Places
Continuation SheetPlummer, Louis, Auditorium
Orange County, CaliforniaSection number 8 Page 1

Historical Significance:

The Plummer Auditorium is significant under Criterion C because it is a very beautiful building with high artistic value. The strong classical design elements and impressive domed tower could have been inspired by the Santa Barbara Mission and the Christian Science Church in Riverside. Important architectural features include the portico which resembles a Roman triumphal arch, the Mission-style pediment and rose window, five-story tower, shed-style wings with red-clay-tile-clad roofs, and west-facing arcade with fifteen arches. Although the building is basically Spanish Colonial Revival in character, Italian Florentine, Renaissance Revival, Mission, Greek and Moorish embellishments add much to the visual character and design. Plummer Auditorium is significant under Criterion A for its contributions to the social, cultural, and educational history of Fullerton. Constructed in 1930 for the Fullerton High School and Junior College District, the building has served as an important cultural center for residents of all ages in the north Orange County area.

Context:

There are several large Spanish Colonial Revival buildings still in existence from the 1920's because Fullerton's most prosperous historic period was from 1917 to 1930. By that time the citrus industry, which became well established around the turn of the century, was in its prime, with miles of mature citrus groves surrounding the city. As Fullerton's main industry, the packing houses shipped thousands of pounds of fruit to all parts of the country, in refrigerated cars. The auditorium was one of the last symbols of prosperity, which ended during the great Depression of the early 1930's. Other large Spanish Colonial Revival buildings of the era which still survive, include the Fullerton Santa Fe Depot, Fox Fullerton Theater, the Muckenthaler home, Chapman Garage, the Dewella Apartments, the Fullerton Police Department building, Hillcrest Park Recreation Center, and several private homes. The book Historical Buildings Survey: Heritage Revisited, published in 1979 by the City of Fullerton, describes the auditorium thusly: "this magnificent Spanish style building is one of the most striking buildings in Fullerton." In terms of architecture, the Plummer Auditorium has a strong design character and artistic value exhibited in no other local building of the style. As a cultural center, it also has no equal. There are no other historic stage/auditorium buildings in the city of Fullerton. The combination of use by the public, the high school, and the junior college for significant events is unparalleled.

Fullerton High School and Junior College:

Fullerton High School served as the main area secondary school for several elementary school districts, both in Fullerton and the surrounding smaller towns. It was a significant player in the city's development of its fine educational system. The Junior College used rooms in the high school buildings until it moved to its own quarters in 1935. It is the only Junior College in north Orange County. The Plummer Auditorium serves as a major cultural center in north Orange County and contributes to the city of Fullerton's fine reputation as a cultural center.

**United States Department of the Interior
National Park Service**

**National Register of Historic Places
Continuation Sheet**

Plummer, Louis, Auditorium
Orange County, California

Section number 9/10 Page 1

Major Bibliographical References:

Fullerton Historic Resources Survey form 1979
Historic Building Survey: Heritage Revisited City of Fullerton, Terry Galvin and Emily Miller 1979; Second Edition 1983
Dedicatory Services program (Sunday, June 1, 1930)
Rededication program: (January 19 and 20, 1972)
Fullerton News, April 25, 1972 Plummer Open in '30, Cost was \$300,000

10: Geographical Data:

The boundaries of the property begin at the corner of Chapman Avenue and Lemon Street as follows:

From the corner go west 123 feet; turn north and go 190 feet; turn east and go 123 feet; turn south and go 190 feet to the point of origin.

Boundary Justification:

Lemon Street, in close proximity to the building, forms the east boundary of the property, minus the sidewalk. Chapman Avenue, approximately 20 feet from the front of the building, not including sidewalk, is the south boundary. The west boundary goes to the sidewalk on the west side. A lawn area extends to the west of the sidewalk. It is approximately 85'x 225'. The north boundary coincides with the back wall of the historic building.

**United States Department of the Interior
National Park Service**Louis Plummer Auditorium
Orange County, CA**National Register of Historic Places
Continuation Sheet**Section number N/A Page

Photographs:

1. Historic photograph, taken in 1931: taken from southwest

Contemporary photographs: Taken Jan-February 1993

Photographer: Diann Marsh

Negatives: City of Fullerton

Fullerton City Hall

303 W. Commonwealth

Fullerton, CA

2. Front Facade: Taken from steps at south end of building, showing details of parapet and front portico.
3. Front Facade: Taken from southwest, on front steps; shows details of doorways
4. Front Facade: Taken from southwest, showing front portico.
5. West Facade: Taken from south. The front facade is on the right, the arcade that runs along the west facade is directly in front of the camera. The tower is on the west facade.
6. West Facade: Taken from the southwest. View of the arcade that runs along the west side.
7. Interior: Taken from west. Decorative balconet located on the diagonal between the west sidewall and the stage area. Note saying in center, below ledge.
8. Interior: South wall, taken from northwest. This is the "back" of the balcony area of the auditorium.
9. Interior: A view of the ceiling, taken from the southwest. Original hand painting is still on beams.
10. Interior: Taken from southeast. This detail of the columns which run down the east and west facades, adds a classical note.
11. Interior: Taken from east: A detail of the cast concrete capitals placed along each side wall.
12. Front Facade: Taken from southeast. Photo shows buildings prominent position on a major corner, Chapman Ave and Lemon St.
13. East Facade: Taken from southeast. The east facade is blank except for the doors at the north end and the entrance on the south end. Note the blind arches with tile cladding above the shed-style roof.
14. East Facade: Taken from east. The tower can be seen above this photo of the east facade. This shows a closer view of the tile-clad blind arch on the second level and the classically-trimmed door on the first floor. The door leads to the rear stage area.
15. East and North Facades: Taken from the northeast. The back of the building is not visible from this street because of the close proximity of the music building.



United States Department of the Interior
National Park Service

JUL 29 1993

National Register of Historic Places Continuation Sheet

ONE

Plummer, Louis, Auditorium
Fullerton, Orange County,
California

Section number 10 Page _____

Geographical Data:

Verbal Boundary Description:

Go west, along Chapman Avenue, for 129 feet; turn north and proceed along the western edge of the sidewalk for 190 feet; turn east and go 93 feet (between the auditorium and the music building); turn south and go 30 feet (along the east wall of the auditorium); turn east and go 36 feet to Lemon Street; turn south and go 160 feet to the point of beginning, at the corner of Lemon Street and Chapman Avenue.

Boundary Justification:

The boundary selected is an arbitrary boundary because the auditorium is in the south-east corner of a high school campus which contains other buildings. We are nominating the auditorium only. The eastern boundary is defined by Lemon Street. The southern boundary is defined by Chapman Avenue. The western boundary is the western side of the sidewalk which is the only visual boundary between the auditorium and the large lawn on the west side. The northern boundary, at the rear of the building, is the rear wall of the auditorium and includes all of the arcade on the west side of the auditorium. On the east side of the rear of the building the line comes back to the line of the auditorium because the music building forms an ell on the east side.

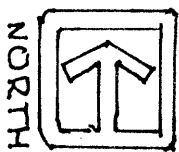
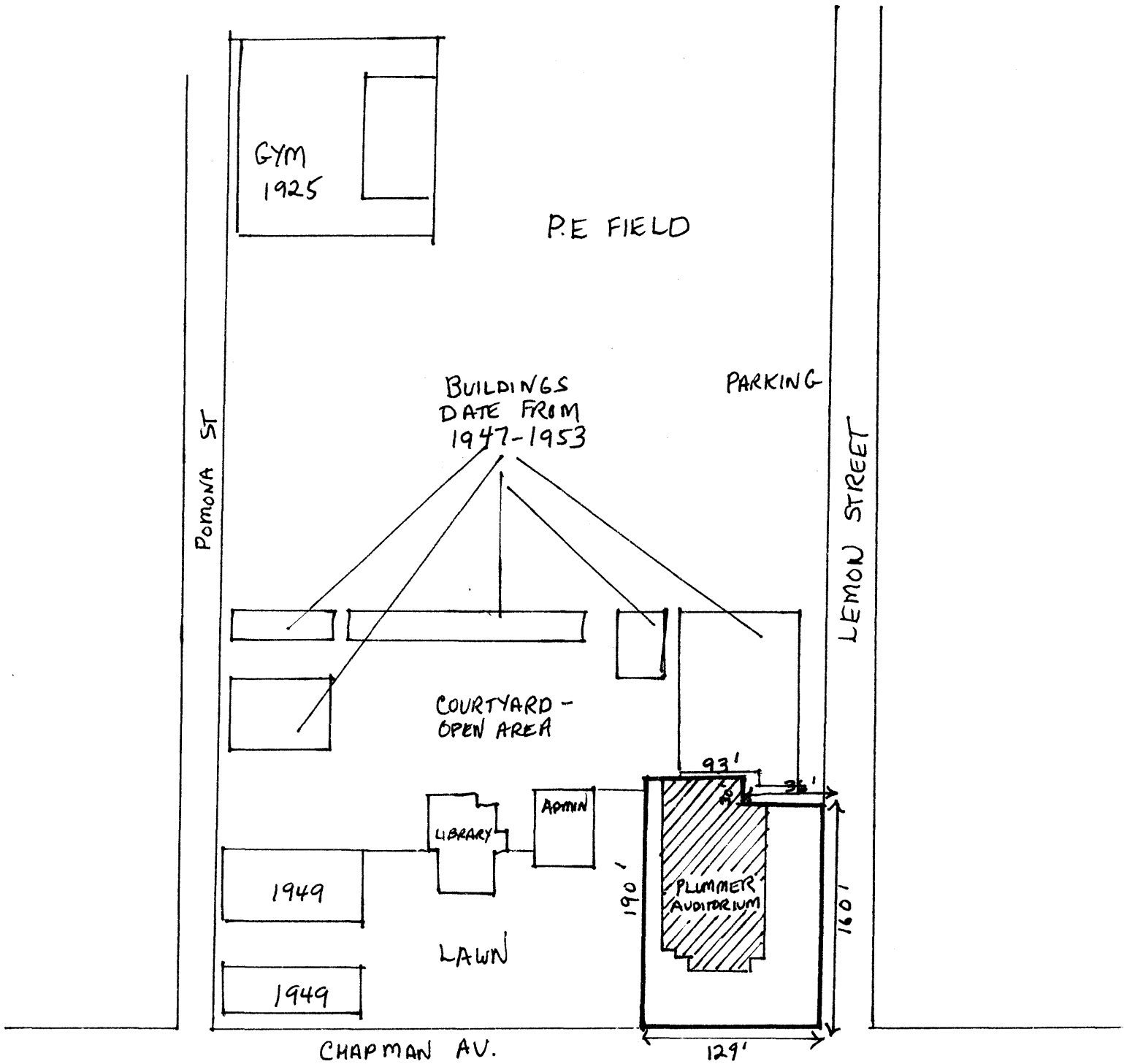

PLUMMER AUDITORIUM
FULLERTON, CA
ORANGE COUNTY

SCALE = 1" = 100'